

# Miller's Mule Pulley Selection Guide

## Stock Fiat Part

## Miller's Mule Equivalent

1995 Water Pump Pulley  
Late 1756 Water Pump Pulley  
For 3.200" (81.2mm) Water Pump  
Stamped and welded steel sheet



260 - Water Pump Pulley Flat



Late 1608 Water Pump Pulley  
Early 1756 Water Pump Pulley  
For 3.200" (81.2mm) Water Pump  
Stamped and welded steel sheet  
Weight: 0.78lbs  
MOI: 2.83lb-in<sup>2</sup>



261 - Water Pump Pulley Short

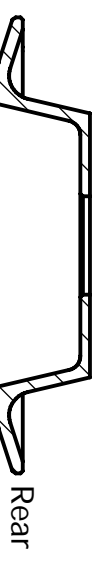

Weight: 0.44lbs  
MOI: 1.38lb-in<sup>2</sup>

Early 1608 Water Pump Pulley  
1592 Water Pump Pulley  
For 3.400" (86.4mm) Water Pump  
Stamped and welded steel sheet

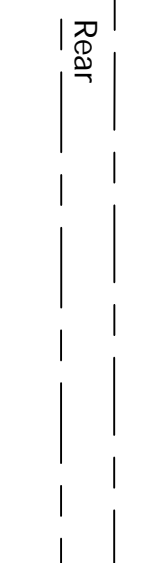

262 - Water Pump Pulley Tall

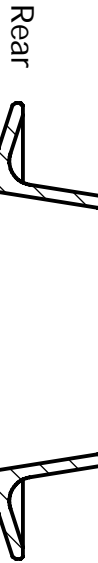

1995 Lancia Crank Pulley  
30mm Bore  
Water Pump and Alternator run on rear groove  
Power steering runs on front  
A/C runs on middle groove  
Grey cast iron

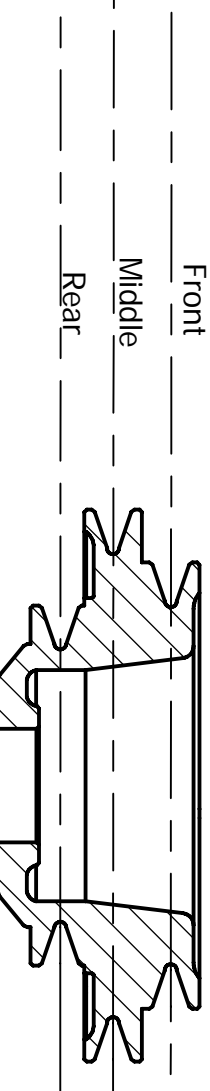

230 - 1608 Crank Pulley Short  
29mm Bore  
+ A/C  
+ Power Steering

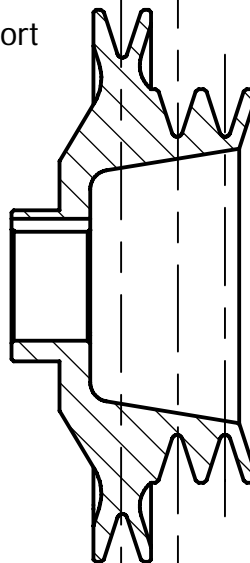

1995 Crank Pulley (US)  
Late 1756 Crank Pulley (US)  
30mm Bore  
A/C or power steering run on front and rear grooves  
middle groove runs alt and water pump  
Grey cast iron

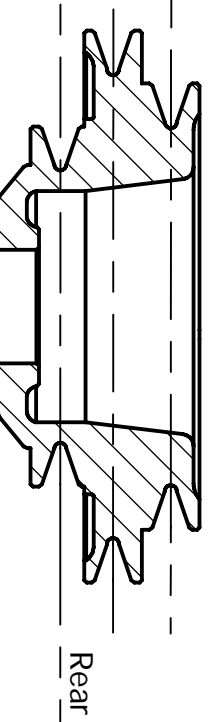

250 - Crank Pulley  
30mm Bore

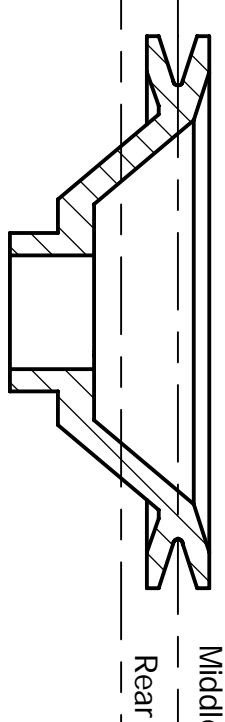

1608 Crank Pulley (US)  
Early 1756 Crank Pulley Short  
29mm Bore  
Alternator and water pump run on rear groove  
Grey cast iron

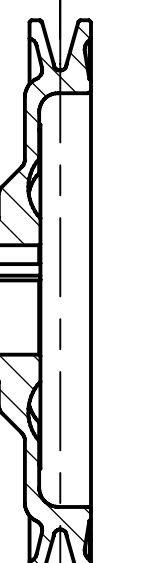

230 - 1608 Crank Pulley Short  
29mm Bore  
251 - Crank Pulley Short  
30mm Bore

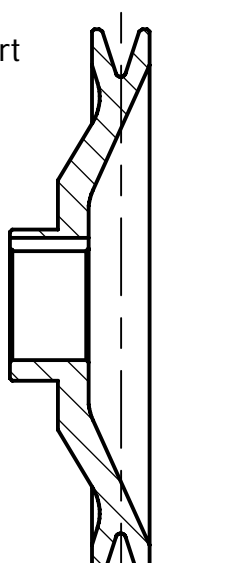

## Water Pump Pulley Guide

First determine which pulley groove you want to run in, middle or rear. Typically the middle groove is used with the alternator on the intake side of the engine, rear groove for the exhaust side.

Once you know which groove you want to use you need to know which water pump you are using. Measuring the water pump height will determine this.

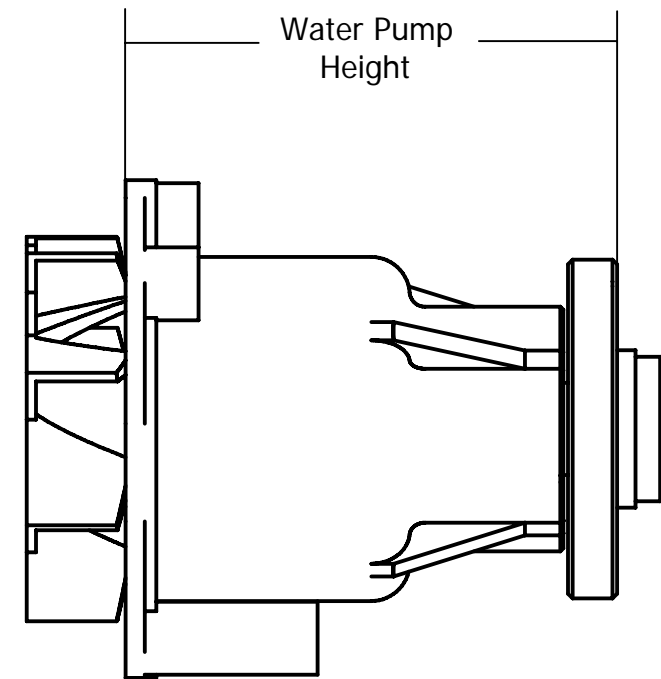

There are 2 different water pumps commonly sold for the DOHC Fiat engines. Some parts vendors are not aware that there are two different parts. This makes it very difficult to determine just based off of year model. Use the water pump height and which groove you want with the information to the left to pick the appropriate pulley.

## Crank Pulley Guide

Choosing a crank pulley can be a daunting task. There are hundreds of combinations to choose from. To get it right you need two main criteria:

1. Choose which crank pulley groove you want to run the alternator and water pump off of.
2. Determine what size the nose of your crankshaft is. This is also the bore of your pulley. See below:

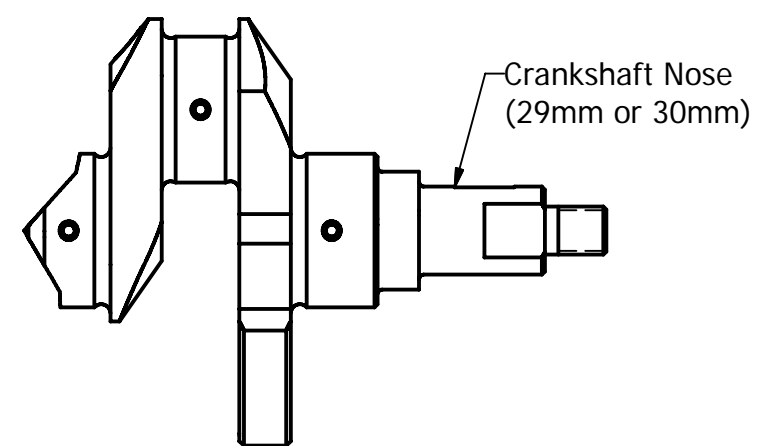

The above will give us enough information to order a basic crank pulley. In addition you can specify additional components listed below:

1. Extra grooves for A/C or Power steering. Please specify where to place the extra grooves.
2. Trigger wheel mounting. All of our pulleys are designed to accommodate a crank trigger. We have experience with most aftermarket ECUs and will clock the trigger as needed.
3. Custom components such as supercharger pulleys, serpentine pulleys and lightening holes.

To the left are just a couple examples of typical pulleys we make. All pulleys can be made with either a 29mm or 30mm bore (1.142" or 1.181")